

**TECHNICAL BULLETIN NO. 20130401**

April 1, 2013

**SUBJECT                                    Microcontroller Replacement Instructions**

**PRODUCT FAMILY                    WatchDog 2000 Series Mini Stations**

**DETAILS**

1. All data currently stored will be lost during the upgrade, download all of the data from the mini station prior to upgrading.
2. Remove the cover from the Mini Station.
3. Remove all batteries and disconnect all sensor wires from the ports on the circuit board.
4. Remove the 4 Phillips head screws on the front of the circuit board.
5. Pull the board straight out of the station enclosure.

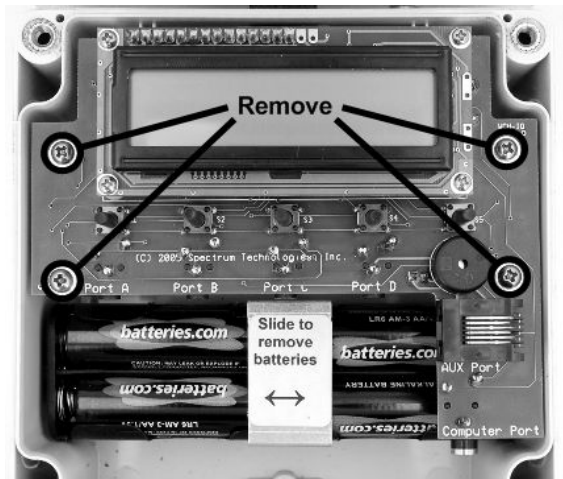

6. Flip over the circuit board and locate the microcontroller chip in its socket. With a small screwdriver or knife, gently pry the chip out of the socket by alternating ends. Grasp the microcontroller by the ends of the black plastic, not the pins.
7. Align the new microcontroller with the socket (note the polarity markings on the microcontroller, the socket, and the circuit board). Be sure all pins are aligned with the socket, and press the chip firmly into place.
8. Place the circuit board back in the enclosure. Be sure the sensor connection pins at the top of the board are inserted into the socket in the enclosure.
9. Reinsert the batteries. The unit should beep when the last battery is inserted, and the display should show the model and serial number, and then ask that date and time be set. If not, double-check that the polarity of the microcontroller and socket match, and that the batteries were inserted properly.
10. Remove the old microcontroller and dispose of it properly

